

Cutout Guidelines For Toughening

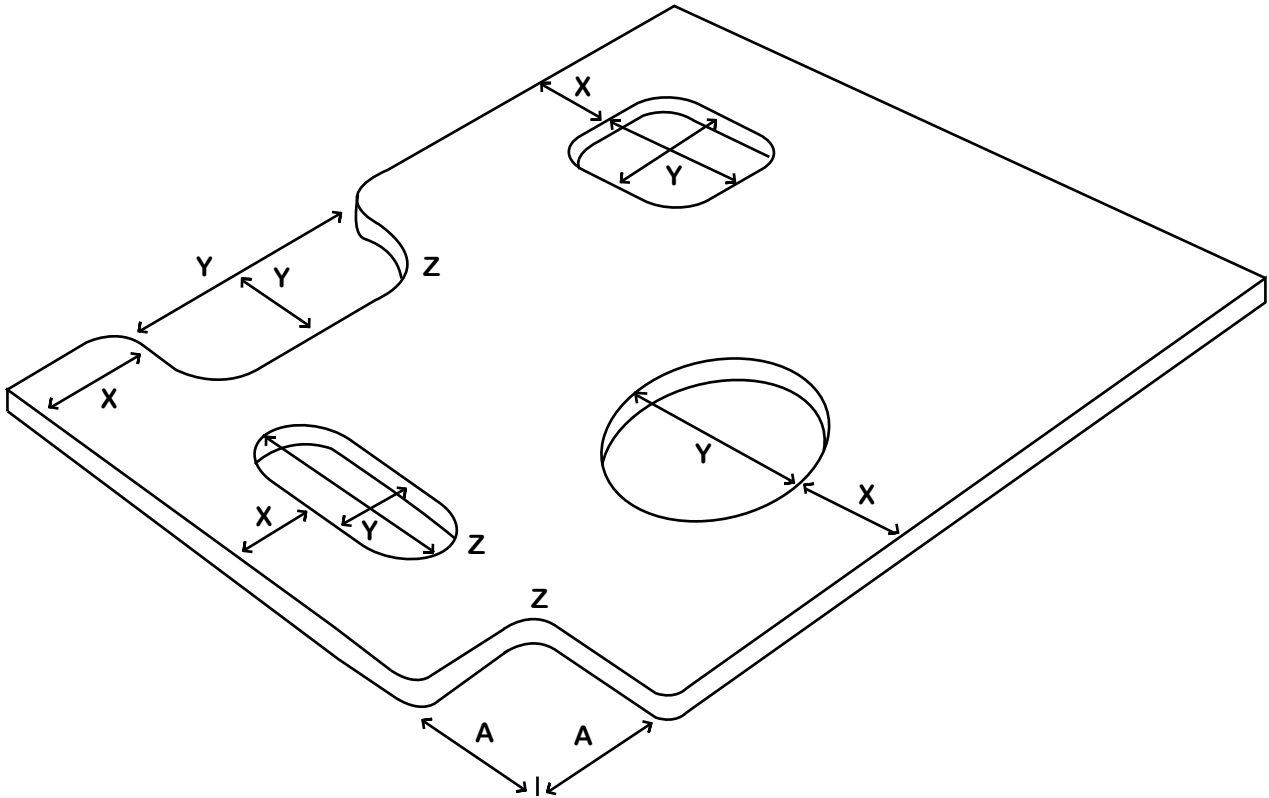

*Distance between holes/centre cut outs must be at least 4x the glass thickness.

*Height/width of the hole/centre cut-out must not be more than 33% of the glass height/width. (Refer Y dimension)

*Dimensions of hole/centre cut-outs should not be less than the thickness of the glass (Refer Y dimension).

*All non circular centre cut-outs must have a minimum radius of not less than the glass thickness. (Refer Z dimension)